

<b>TITLE PLAN</b>	<b>EDITION 1</b>	<b>TP963080P</b>
-------------------	------------------	------------------

LOCATION OF LAND

PARISH MOORABBIN  
PART OF DENDYS CROWN SPECIAL SURVEY

SECTION -

CROWN ALLOTMENT -

CROWN PORTION -

LAST PLAN REFERENCE LP11490

DEPTH LIMITATION DOES NOT APPLY

TITLE REFERENCE VOL.8154 FOL.447

MGA CO-ORDINATES E 326 675  
(APPROX. CENTRE OF LAND IN PLAN) N 5 801 490 ZONE 55

WARNING  
THIS PLAN REPRESENTS AN EXPECTED DIVISION OF LAND.  
ANY ONE LOT MAY NOT HAVE BEEN CREATED.  
CHECK THE LOT/PLAN INDEX FOR CURRENT INFORMATION.

NOTATIONS

THIS PLAN IS NOT BASED ON SURVEY.

**EASEMENT INFORMATION**

LEGEND E - ENCUMBERING EASEMENT OR CONDITION IN CROWN GRANT IN THE NATURE OF AN EASEMENT OR OTHER ENCUMBERANCE  
A - APPURTENANT EASEMENT R - ENCUMBERING EASEMENT (ROAD)

EASEMENT REFERENCE	PURPOSE	WIDTH (METRES)	ORIGIN	LAND BENEFITED/IN FAVOUR OF
E-1	AS PROVIDED FOR IN SEC 528(2)(e) LGA 1958	3.05	SEC 528(2)(e) LGA 1958	MELBOURNE WATER

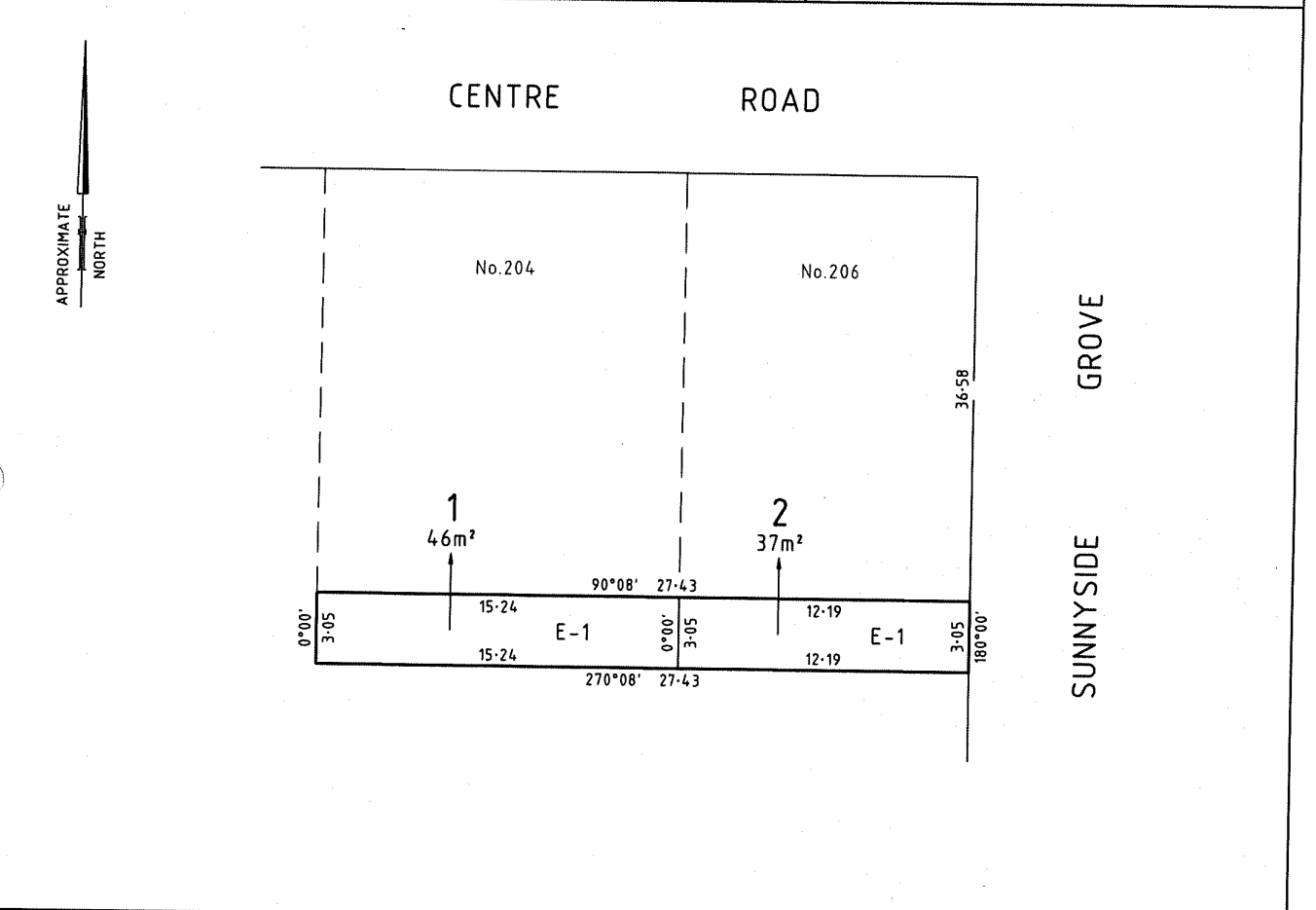

SCALE 1:200

0 2 4 6 8 10  
LENGTHS ARE IN METRES

SHEET 1 OF 1 SHEET  
ORIGINAL SHEET SIZE: A2

**BARKER MONAHAN**  
A.C.N. 005 394 865  
SURVEYORS, DEVELOPMENT AND  
LOCAL GOVERNMENT CONSULTANTS  
581 GILBERT ROAD, PRESTON 3072  
P.O. BOX 2546 REGENT WEST 3072  
TELEPHONE 9478 6133 FAX 9470 5189  
EMAIL: survey@barkermonahan.com.au

LICENSED SURVEYOR . . . . . DAVID JOHN MONAHAN

SIGNATURE . . . . . DATE / /

REF. 18384                      VERSION 01  
COMPUTER FILE: 18384.TP.DWG                      DATE: 23/07/2018

FILE NO : LGD

DEALING CODE : LGA

